

the BRIGGAI



COLLECTIVE ARCHITECTURE

This book is part of a series documenting a work in progress by Collective Architecture in June 2015.

Each book has been specially made for the 'HOME from HOME' exhibition held in Brixton, London
between 18/06/15 and 21/06/15 as part of the London Festival of Architecture Open Studios.



BRIGGAIT Creation Centre, Glasgow

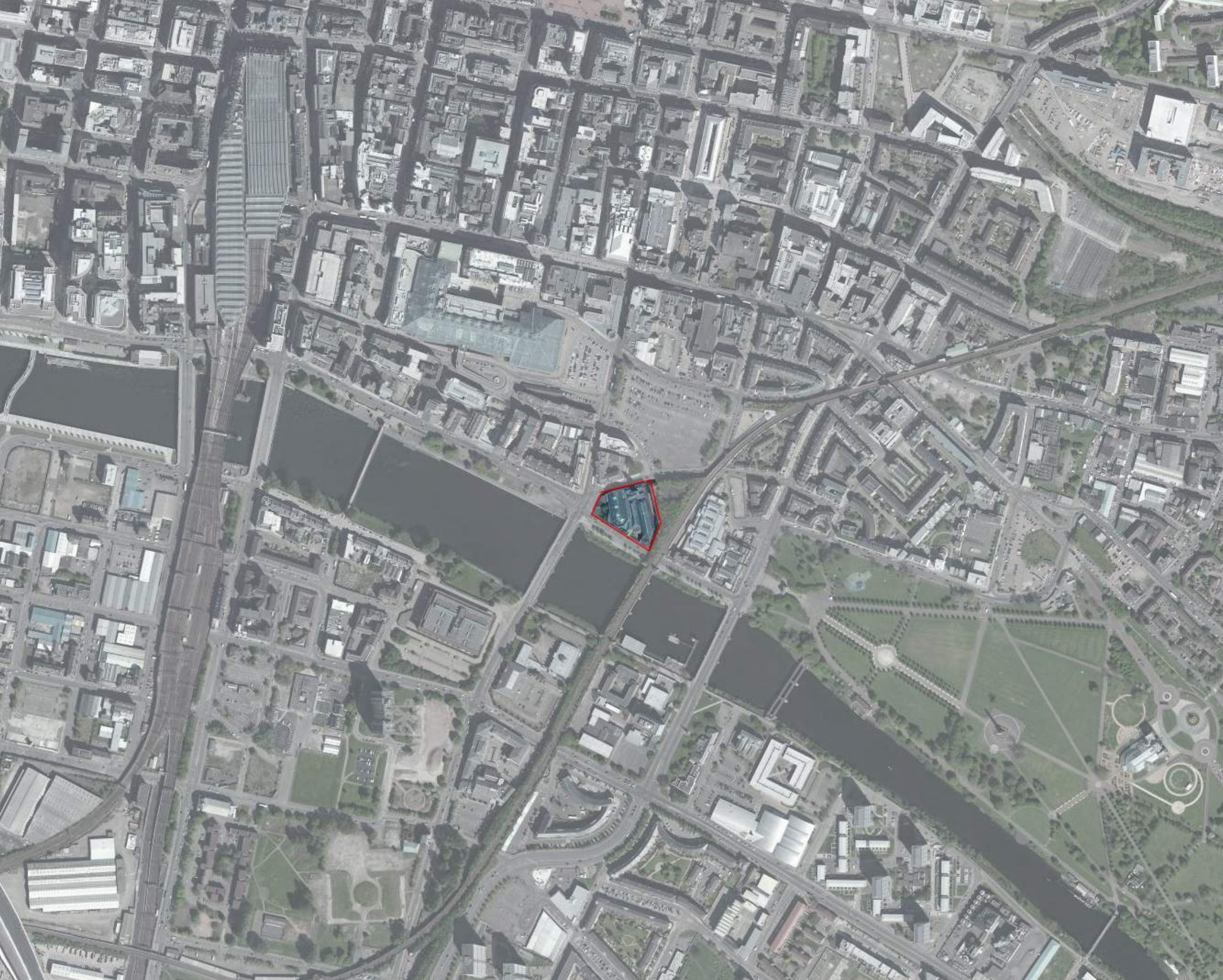

The building was originally used as Glasgow's fish market until the late 1970s. It was then converted into a shopping centre during the 1980s. In the 21st century, part of the site was converted into artists studios which opened to the public in August 2010. The steeple which dates back to 1665 has been restored.



Existing Elevations



Aerial View of the Briggait



Existing Building

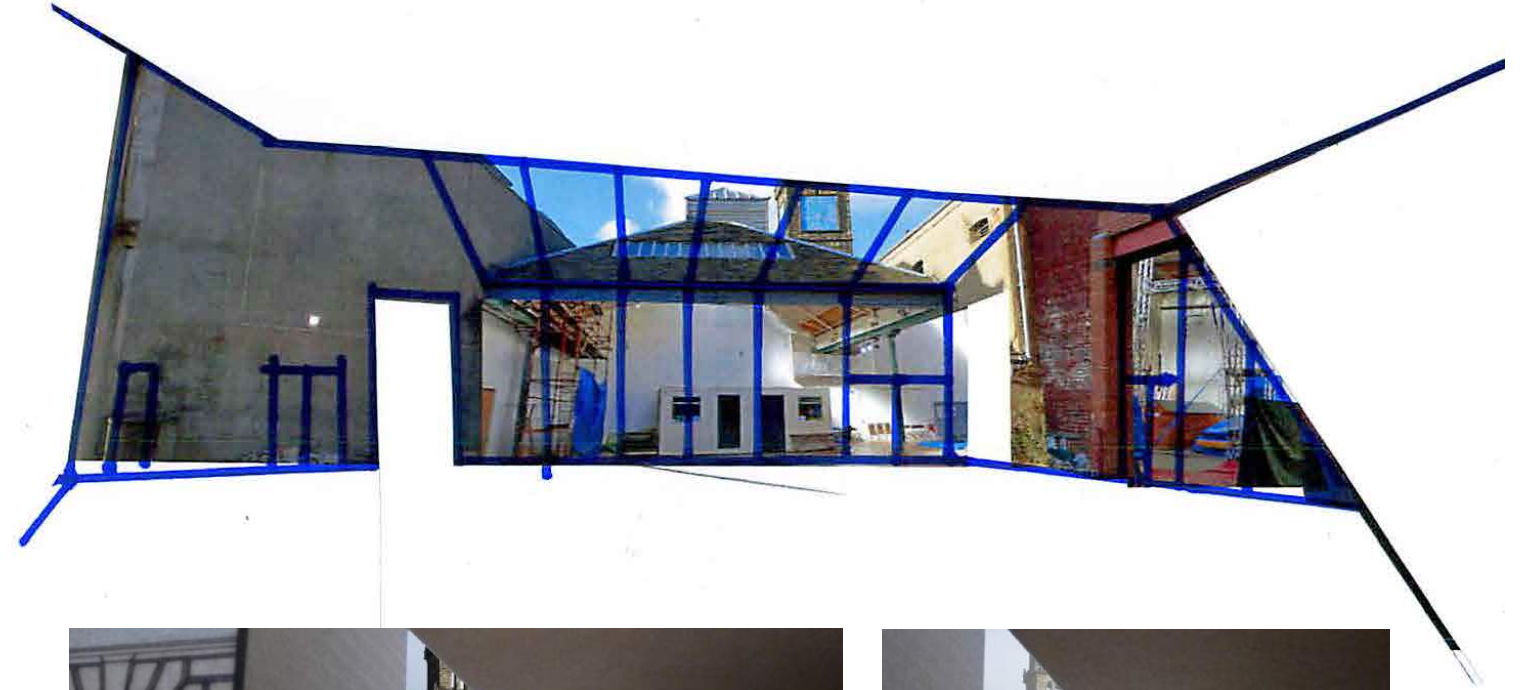

Concept Diagram inside existing structure | study models

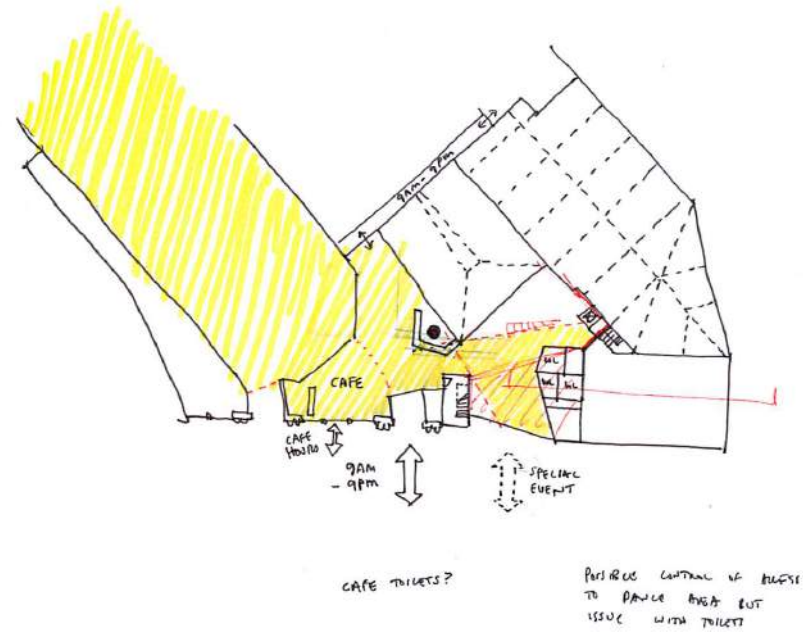

Access and Public Transport

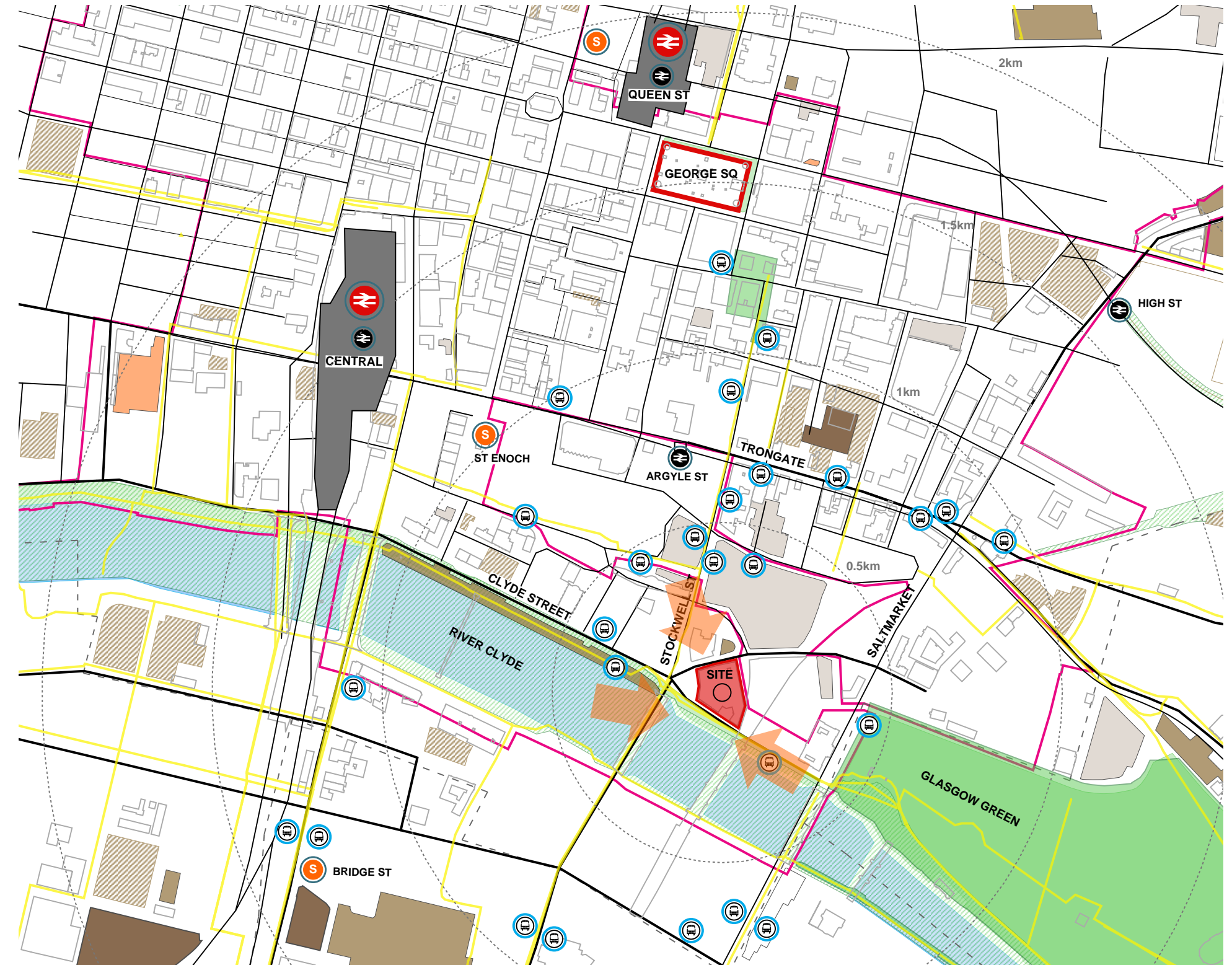

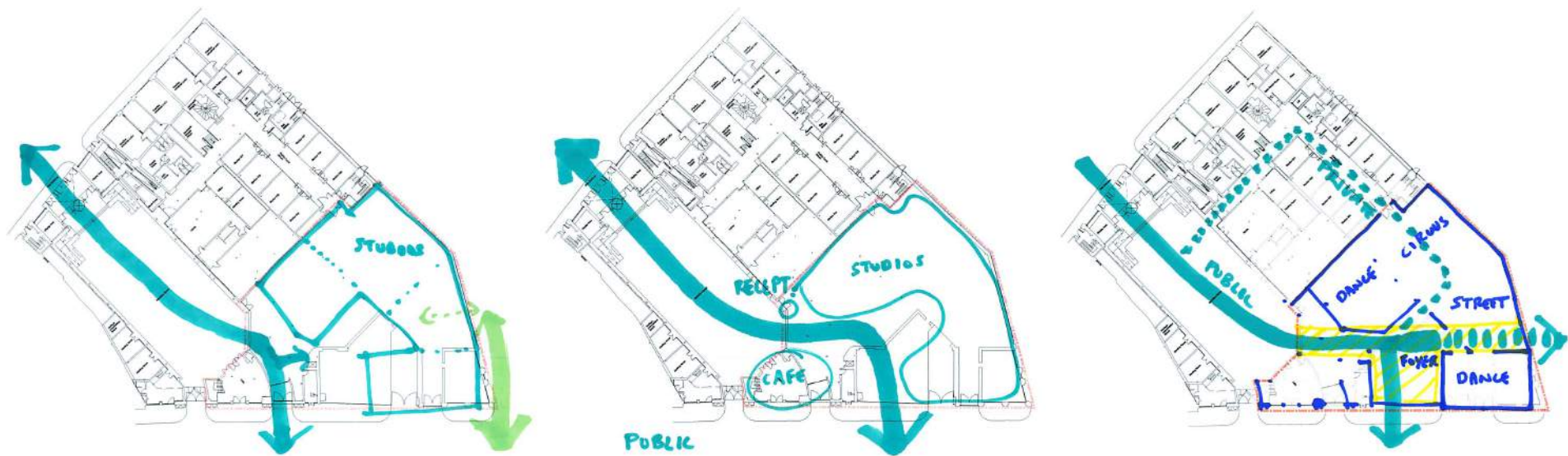

Public Route Options



Access Issue



Reception Desk Location Studies



Reception Desk Location Studies



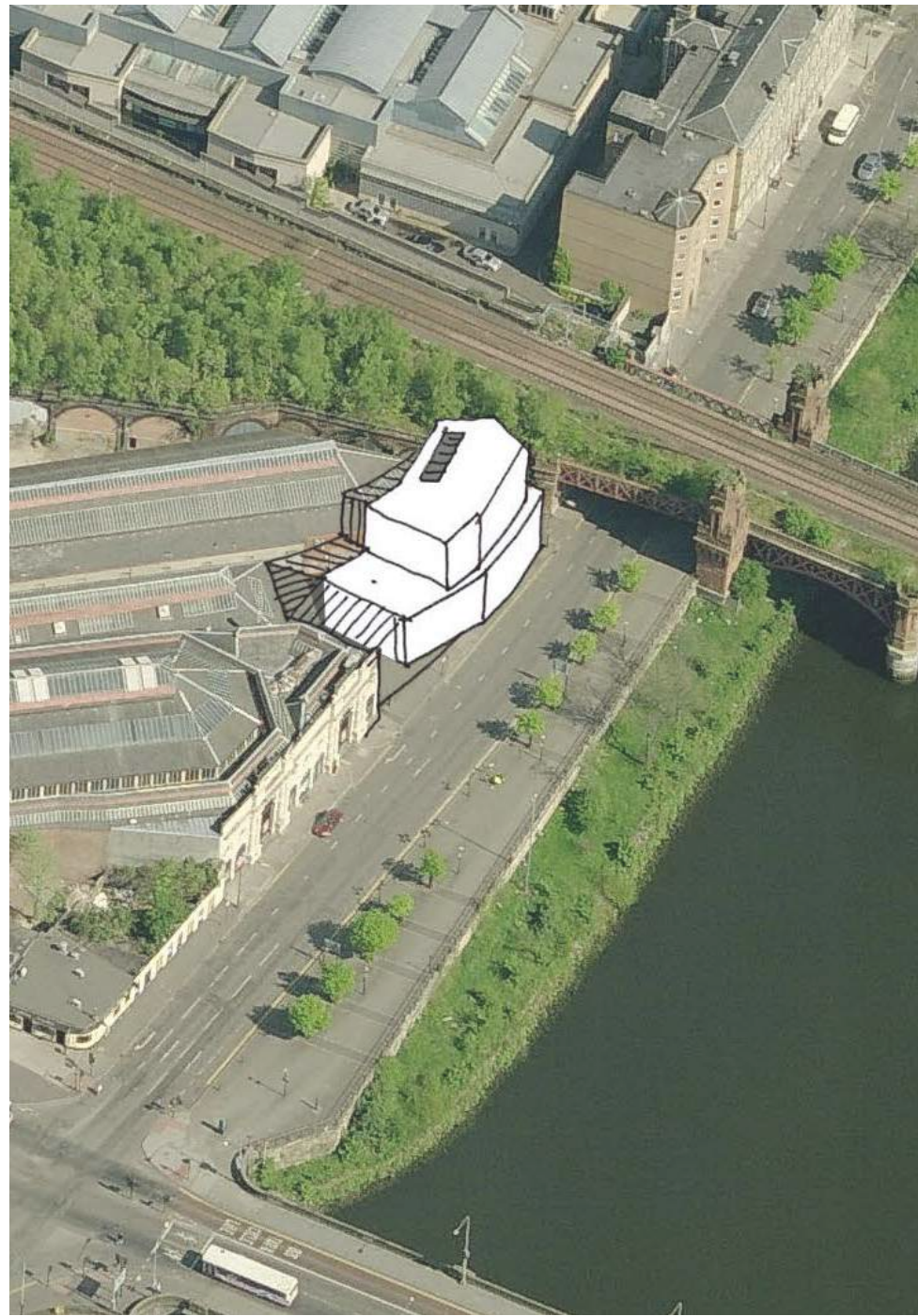
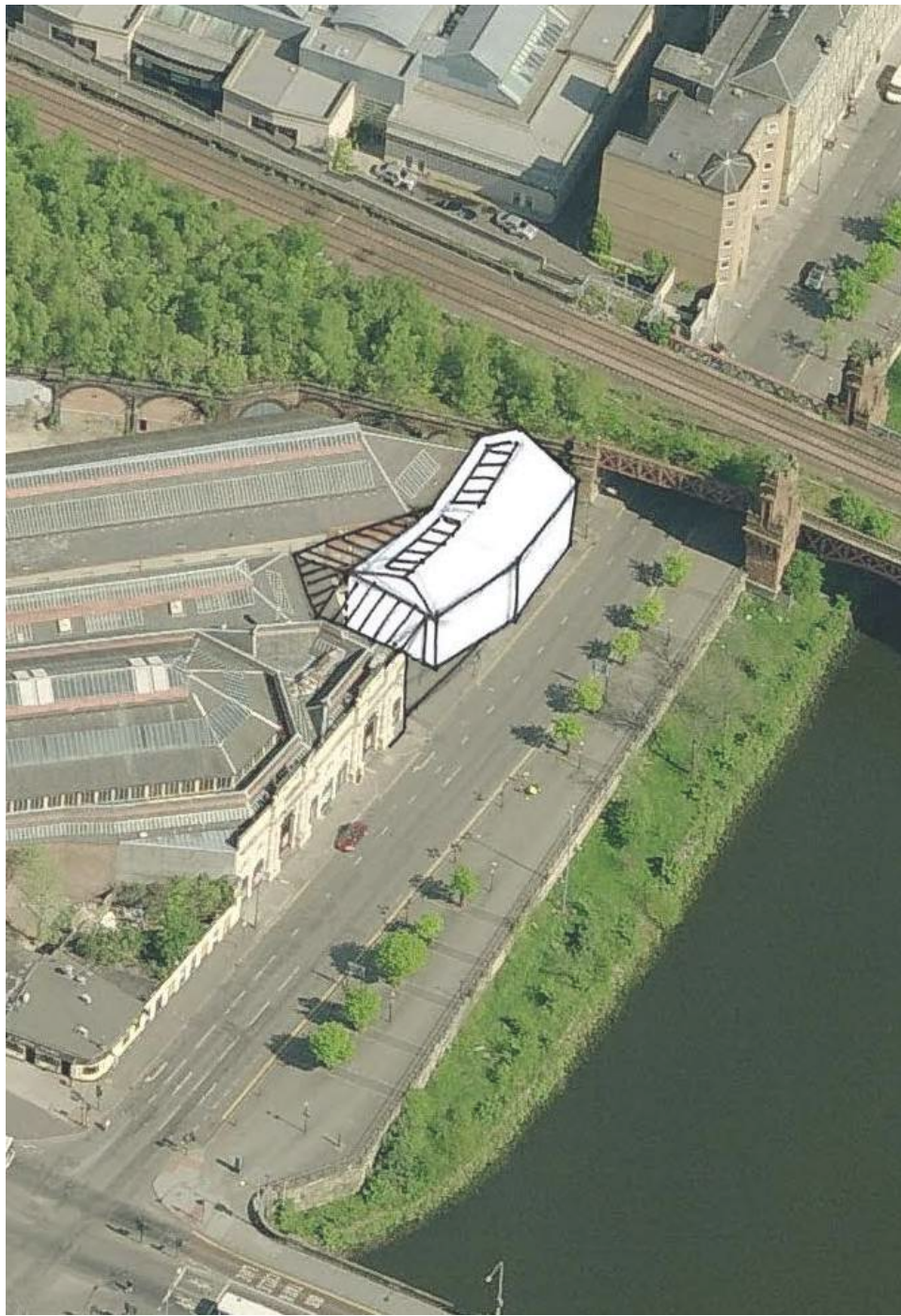

Layout studies



Client Consultation and Workshop



Atrium concept



Extension massing

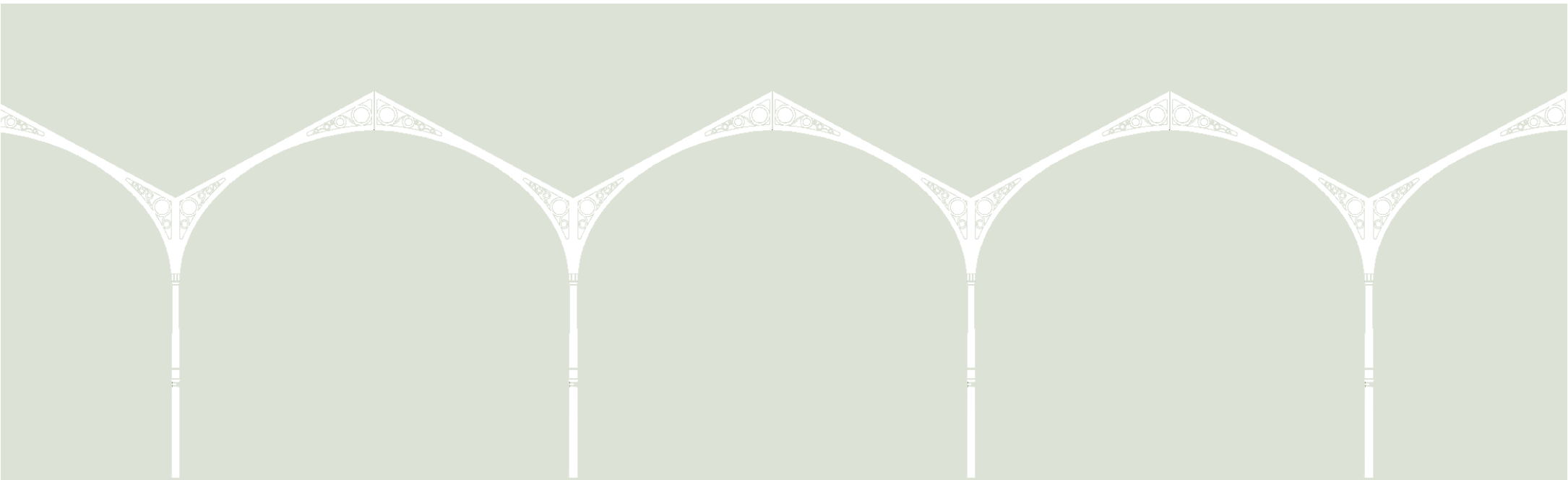

edition for HOME from HOME
June 2015